

DESKTOP CARD ISSUANCE PRINTER AND EMBOSSE

MODEL: PIE001-B

As part of Goldpac’s desktop card issuance printer series, the PIE001-B is a one-stop card issuance solution offering onboarding, card personalisation, and instant card printing with indenting and optional embossing modules. Its portable size, dual monitors, and built-in PC allow staff to conveniently issue various types of payment, identification, and membership cards right at their desks.

The PIE001-B can collect a range of data for all-in-one onboarding and card issuance, as well as integrate with issuance systems to perform instant card printing and embossing tasks.



SUITABLE FOR

Banks, corporate, retail, government, hospitality



PAIN POINTS

- Challenge of handling multiple hardware
- Space constrained
- Complicated devices
- Limited card printing effects in most desktop devices

KEY BENEFITS

- ✓ All-in-one unit (no laptop PC required)
- ✓ Small and portable touchpoint
- ✓ Address onboarding and card returns
- ✓ Indenting and embossing modules
- ✓ Enhance service speed and quality

DEVICE FUNCTIONS

- **Instant issuance** of many card types including debit, credit, social welfare, transportation, and high-end customisable cards
- **Business functions:** New card issuance, card replacement with the same number, customised card surface design, account enquiry and update
- **Secure data functions:** Provides encryption and secure transmission of related sensitive data. Supports integration into banks’ secure CRM systems and IoT SDK. Self-deletion of card issuance data.
- **Optimised printing success rate:** Maximises use of card materials with “Retry” option when encountering printing errors to reuse existing card materials
- Integrated with the **Goldpac Issuance Suite** for personalisation bureau management and remote instant issuance



WWW.GOLDPAC.TECH

PIE001-B SPECIFICATIONS

Binocular Camera
Facial recognition, QR code scanner
Built-in, 720P

Top Printer Card Output Slot
300dpi
Full Colour/ Monochrome Printing
Single/Double-sided Printing

Encryption PIN Pad
DES / 3DES / MAC Support

Contactless ID
Card Reader

Embossers Card Output Slot

Contactless IC
Card Reader

Speakers

Contact Pen

10" Touch Screen Monitor
(Client facing)

Features	Description
Dimensions	Top component: 220mm (width) x 520mm (length) x 290mm (height) Embossers: 410mm (width) x 620mm (length) x 290mm (height)
Weight	Combined: 28kg, top component: 13kg
Interface	USB (2 ports or more), WIFI, bluetooth, 5G
Card Hoppers	Input hopper capacity: 100 cards, recycle hopper capacity: 30 cards
Binocular camera	Supports facial recognition, liveness detection, auto white balance, adjustable angles, d-range optimiser, and QR code scanner
Fingerprint Sensor	Complies with universal banking fingerprint scanning standards
Display	Client-facing monitor: 10-inch multi-touch screen, 1280*800 resolution; waterproof, dust-proof, privacy filter; includes contact pen; hard encryption, capable of encrypting and transmitting e-signature tracking data and vector images. Staff-facing monitor: 10-inch capacitive multi-touch screen, 1280*800 resolution.
Basic Configuration	Contactless ID and IC card readers, encryption PIN pad (features can be configured according to customer requirements)
PC Configuration	PC supports Android 12 and Windows 10. Processing core of 8 or higher (speed of 2.2 Ghz or higher), 8G memory, 128 GB storage. Motherboard utilises low energy consuming, portable solutions for enhanced heat dissipation.

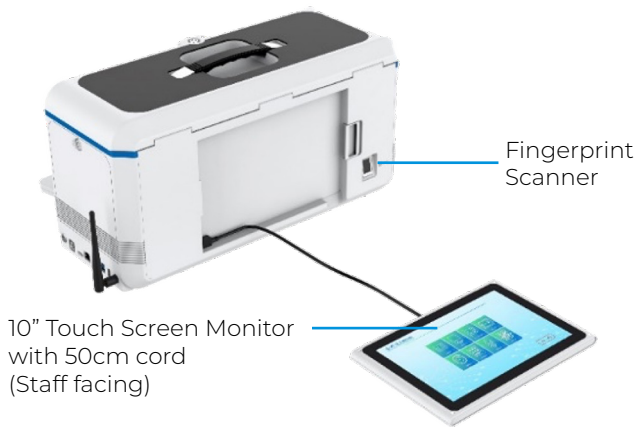

DEVICE FEATURES

- Built-in PC eliminates need for external laptop PC
- Customisable module setup for flexible configuration
- Dual monitors for multi-directional synchronised display
- Fully sealed and locked card hoppers without the need for manual card refilling or removal for added security
- Equipped with PSAM card
- Theft-proof exterior material



Features	Description
Card Printer	300 DPI/ 300*600DPI/300*1200DPI direct-to-card thermal transfer
Printing Side	Double-sided
Printing Performance	Monochrome thermal printing and indent: ~70 seconds/card; One-sided colour (YMCKT) and indent: ~90 seconds/card; Embossing and indent: ~80 seconds/card; (includes processes of card issuance, personalisation, and encoding on magstripe)
Card Hoppers	Input hopper capacity: 100 cards, recycle hopper capacity: 30 cards
Magnetic Stripe	ISO standard, 3 tracks, HiCo
Smart Card	ISO standard, contact & contactless
Indent Printing	Inside card printer component, utilises indent CVN numbers (0-9 digits), provides error message for unindentable data. Text and symbols cannot be indented, need to be embossed.
Embossing Module	Optional external embossing module, supports a minimum of 72 characters; includes tipping module to apply colour foil onto embossed text

About Goldpac

Goldpac provides products and solutions that addresses the financial industry's diverse needs for secure, convenient, and easy-to-use payment solutions. These solutions cover user onboarding, personalisation and payment device issuance systems, software, self-service kiosks, and desktop printers.

For more information, please contact us at info@goldpac.tech.